

High-Resolution Color Covert PIR Housing Camera



Product Summary

The A-CC54PIR is a high-resolution color camera housed in a non-working PIR housing. The camera is designed specifically for interior applications in general commercial and retail environments when general covert video surveillance is required.

The unique PIR camera provides general scene coverage in most applications and aids in the identification of a person's movement within a defined area and may substantiate a suspect's entry, exit and movement within a facility.

The A-CC54PIR features a high-resolution 540TVL color camera with an integrated 5.5mm wide angle lens offering a 55° viewing angle for excellent wide angle image capture. The camera offers adjustment in pan and tilt angles to customize the image view.

The camera is housed in a white colored non-working PIR housing with a red LED which is illuminated in normal operation. The LED offers the appearance of a working security system PIR detector. Audio capability is not permitted with this covert camera.

The camera features the easy to connect modular RJ-11 wiring configuration and connects to all video security equipment using the CONKIT series interface adapters (1-ch to 16-ch). Each camera includes a 60-ft modular cable and a camera wall mount.

Features

- High-resolution 540TVL color camera
- 55° wide-angle, 5.5mm lens
- Red illumination LED
- Modular cable - 60-ft
- White case color
- Wall mount included
- Option CONKIT for non-RJ-11 applications

Ordering Guide:

SCN#	Item
A-CC54PIR	540TVL, Covert Color Camera, non-working PIR housing, white case



ADT Always There®

Specifications

Model

A-CC54PIR 540TVL, Covert Color Camera, non-working PIR housing, RJ-11, white case

Video

Image Sensor 1/3" SONY Super HAD CCD
 Total Pixels 811 (H) x 508 (V)
 Scanning System NTSC
 Scanning Frequency 15.734KHz(H), 59.94Hz(V)
 Sync. System Internal
 Resolution 540TVL
 Min. Illumination 1.0 lux @ F1.2, 50 IRE
 Video Output 1.0Vp-p (75-ohm, composite), 6-pin modular
 S/N Ratio more than 50db (AGC off)

Function

Electronic Iris 1/60 ~ 1/100,000
 White Balance ATW, fixed
 Gain Control Auto
 Gamma 0.45
 BLC ON

Mechanical / Other

Power +12~15VDC, RJ-11, 6-pin modular
 Video 1.0Vp-p composite, RJ-11, 6-pin modular
 Lens 5.5mm, F1.6, Fixed iris
 Operating temperature 32°F ~ 104°F (0°C ~ 40°C)
 Operating humidity 0 ~ 96% (non-condensing)
 External dimension 2.75" x 3.94" x 1.78"
 (W x H x D) (69.7mm x 100mm x 45.2mm)
 Weight 3.17oz, (90g)

Standards Compliance FCC, cULus, RoHS

Specifications are subject to change without notice.

Dimensional Drawings

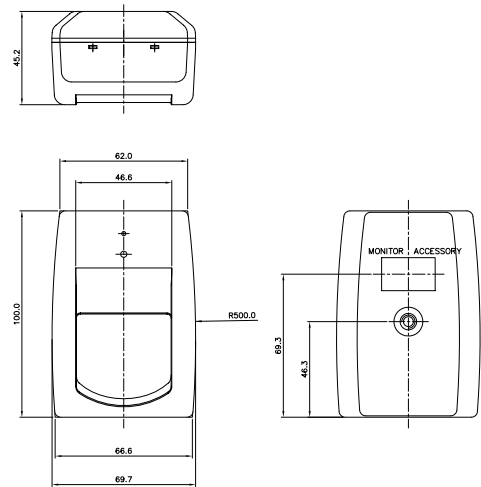

Optional Accessories

Part Number	Description
A-A18C	60' Camera cable
A-A30C	100' Camera cable
A-A60C	200' Camera cable
A-A90C	300' Camera cable
A-MA800	Modular cable adapter
A-LA800	Line Amplifier, for camera runs over 300'
CONKIT	1-ch A/V/A Interface
CONKIT4C	4-ch A/V/A Interface with cables
CONKIT9C	9-ch A/V/A Interface with cables
CONKIT16C	16-ch A/V/A Interface with cables
1512AC	BNC / Power Pin adapter to RJ-11



ADT Always There®